



SCHOOL REVIEW PROCESS

Impact Assessment Report Sackville Centennial Elementary School

For more information, please contact: Jill McGillicuddy, 464-2000 ext.2277

TABLE OF CONTENTS

1.0 Introduction	4
2.0 School Information	
2.1 School Name	4
2.2 School Configuration	4
2.3 School Location	4
2.4 Administration	4
2.5 Population Patterns	
2.5.1 Projection Methodology	5
2.5.2 Halifax Regional Municipality Historical and Projected Population	7
2.5.3 Central HRM Planning Area Historical and Projected Population	7
2.6 Enrolment	
2.6.1 Historical and Projected Enrolment for HRSB 1998/1999 to 2017/20189	9
2.6.2 Sackville High Family Historical and Projected Enrolment by Grade	10
2.6.3 Sackville Centennial Elementary School Historical and Projected Enrolments	10
2.6.4 Sackville Centennial Elementary School In and Out of Boundary Details	10
2.6.5 Sackville Centennial Elementary School Registered Enrolment for September 2011	11
2.7 Capital Construction Planning	
2.7.1 Halifax Regional Municipality Regional Plan	11
2.7.2 HRM Facility Master Plan	12
2.7.3 Community Visioning	12
2.7.4 Proposed Development	12
2.8 Physical Condition of Building	
2.8.1 Condition of Building Envelope, Interior and Systems	12
2.8.2 Indoor Air Quality and Environmental Issues	12
2.8.3 Costs Associated with Maintenance, Repair and Operation	13
2.8.4 Barrier Free Accessibility to Building and Grounds	13
2.9 Building Use	
2.9.1 Floor plan	14
2.9.2 Building Details	15
2.9.3 Teaching Spaces and Current Usage	15
2.9.4 Excess Teaching Spaces	15
2.9.5 Sackville Centennial Elementary School Boundary	16
3.0 Impact Analysis	
3.1 Capability to Deliver Public School Program	18
3.1.1 Facility Program Delivery Review	19
3.1.2 Public School Programming	20
3.2 Educational Benefits	20
3.3 Transportation	20
3.4 Extra-Curricular Activities	20
3.5 Operational and Capital Requirements	
3.5.1 Completed Capital Projects at Sackville Centennial	20
3.5.2 Immediate Operating Needs (5 years)	20
3.5.3 Capital Investments on Current Building	21
3.6 Property Service Efficiencies	21
3.7 Impact on the Community	22
3.8 Community Use of the School	22

3.9 Impact of Potential Consolidation (if applicable)	22
4.0 Proposed Receiving School Information	
4.1 School Name	23
4.2 School Location	23
4.3 Administration	23
4.4 Enrolment	
4.4.1 Hillside Park Elementary School Historical and Projected Enrolments	23
4.4.2 Hillside Park Centennial Elementary School In and Out of Boundary Details	23
4.4.3 Hillside Park Centennial Elementary School Registered Enrolment for September 2008	24
4.4.4 Impact of the Review Outcome on Hillside Park Elementary School	24
4.5 School Configuration	24
4.6 Physical Condition of the Building	
4.6.1 Facility Utilization	24
4.6.2 Condition of Building Structure and Systems	24
4.6.3 Costs Associated With Maintenance and Operation	25
4.6.4 Operation and Availability of Accessibility Ramps, Elevators, Accessible Playgrounds	25
4.7 Building Use	
4.7.1 Excess Space	25
4.7.2 Teaching Spaces and Current Usage	26
4.7.3 Impact of Increased Number of Students on Building Usage	26
4.8 Transportation	26
4.9 Proposed Attendance Boundary	27

Supplementary Information

Building Audit and Expenditure Plan - Sackville Centennial Elementary and Hillside Park Elementary

Halifax Regional School Board Facilities Master Plan (pending approval-tabled March 2011)

Halifax Regional Municipality Regional Plan

Halifax Regional Municipality Facilities Master Plan

1.0 INTRODUCTION

Recently, the Halifax Regional School Board has undertaken a 10 year facility master planning process which resulted in a staff report and recommendations which were presented to the Governing Board in February 2010 <http://www.hrsb.ns.ca/files/Downloads/pdf/reports/2009-2010/February/10-01-1236.pdf>. The Governing Board requested the facility master plan be prepared and presented in smaller components.

**It was moved and seconded (Conrod/Finlayson) that the Board request staff to develop an approach or process that would divide the capital construction master plan into more manageable components---for example, area-by-area or family-by-family, and that staff review this approach or process, including a timeline, with the Board before it begins.
(CARRIED)**

During the 2010-2011 school year, staff prepared a facility master plan that is divided by family of schools. The plan outlines the historical information, demographics, feeder system – existing and proposed, and requested capital project for each area. The staff report and proposed facility master plan was tabled at the Board meeting of March 30, 2011.

The Capital Plan has identified a number of schools that should be considered for review as part of the ongoing planning process. Catchment areas that are experiencing enrolment decline provide opportunities to consolidate populations into existing infrastructure, renovated or replacement schools.

Sackville Centennial Elementary School has been identified for possible consolidation with Hillside Park Elementary School. The potential receiving school, Hillside Park Elementary would not require capital improvements to accommodate the potential student population.

The information in this report has been compiled in accordance with Provincial school review regulations and outlines information for the School Review Committee to consider regarding possible impacts of the Sackville Centennial Elementary School review.

2.0 SCHOOL INFORMATION

2.1 SCHOOL NAME

Sackville Centennial Elementary School

2.2 SCHOOL CONFIGURATION

Primary to Grade 6

Regular Program

2.3 SCHOOL LOCATION

2A George St

Lower Sackville, NS B4C 2M5

2.4 ADMINISTRATION

Principal: Sue Fetterly

Vice Principal: N/A

2.5 POPULATION PATTERNS

2.5.1 Projection Methodology

Paradigm Shift Inc.

Currently, the Board has the advantage of reviewing projections as prepared by two demographic systems. The “Imagine our Schools” consultants submitted projected demographics as prepared by Paradigm Shift Inc. The methodology that was applied included the cohort-survival method combined with the residual method.

The cohort survival method applies historical census data and projects future population based on assumptions about births, deaths, and migration. The residual method is derived from a calculation of population between two points in time for which population data is available using the Cohort Survival Method. Additionally, the consultants worked closely with the Halifax Regional Municipality in determining approved/potential development areas.

Baragar Demographics

The Halifax Regional School Board has purchased planning software from Baragar Demographics and as part of the licensing agreement, the company provides the Board with projections for each school on a yearly basis.

Baragar Demographics applies a similar methodology as Paradigm Shift Inc. Their data analysis includes:

- Analysis of yearly birth records;
- Determining the number of children who reside in a boundary by accessing the Universal Child Care Benefit tax records and Canada Child Tax Benefit records on a yearly basis;
- Applying census information such as women of child bearing years, generally in the age cohorts of 25-29, 30-34, and 35-39; and
- Applying a historical migration rate (+/-) of the boundary.

Upon comparison, the projections as prepared by each company are relatively close. Paradigm Shift has not been asked for updated projections since 2009, resulting in stale-dated data in later years. Baragar Demographics provides yearly projections and as such is the projection software package that will be utilized on a go forward basis.

2.5.2 Halifax Regional Municipality Historical and Projected Population

Historical

- The total population of Halifax Regional Municipality (HRM) increased by 8.8% from 1996 to 2006; however, during this same period the age 5 to 19 population decreased by 0.9%.
- The age 0 to 4 population decreased significantly from 6.6% of the total population in 1996 to 4.9% of the total population in 2006.

Projected

- The age 5 to 19 population comprised of 17.8% of the total population in 2006 with this value is estimated to steadily decline to 13.4% in 2021.
- The age 5 to 19 population will continue to decrease resulting from the lower age 0 to 4 population that will move into the older age cohorts.
- The age 0 to 4 population is expected to remain stable due to a projected value of approximately 3800 live births per year.

Halifax Regional Municipality Historical and Projected Population

Age Cohort	1996	2001	2006	2011	2016	2021
0 to 4	22,460	19,925	18,205	18,104	18,311	18,368
5 to 9	23,675	22,365	19,645	17,957	17,873	18,080
10 to 14	22,040	23,685	22,325	19,608	17,924	17,842
15 to 19	21,190	22,905	24,340	23,025	20,274	18,510
20 to 24	25,570	26,560	28,120	29,842	28,868	25,938
25 to 29	27,950	26,440	26,015	27,578	29,262	28,261
30 to 34	33,195	27,600	25,850	25,461	27,025	28,676
35 to 39	31,980	32,850	27,405	25,677	25,294	26,852
40 to 44	28,080	31,645	32,745	27,336	25,601	25,214
45 to 49	25,765	28,070	31,565	32,675	27,327	25,569
50 to 54	19,075	25,525	28,235	31,741	32,913	27,674
55 to 59	14,155	18,335	25,065	27,778	31,229	32,402
60 to 64	12,305	13,670	18,235	24,898	27,819	31,262
65 to 69	10,595	11,840	13,210	17,525	23,918	26,896
70 to 74	9,415	9,715	11,010	12,327	16,254	22,172
75 to 79	7,055	8,060	8,560	9,677	10,854	14,197
80 to 84	4,610	5,535	6,475	6,924	7,771	8,719
85 to 89	2,325	2,880	3,735	4,420	4,758	5,301
90 and over	1,230	1,505	1,935	2,476	3,014	3,400
Total Population	342,670	359,110	372,675	385,029	396,289	405,333

Sources: Statistics Canada (historical), Environmental Design and Management Ltd.
 Figures do not include Census under-count.

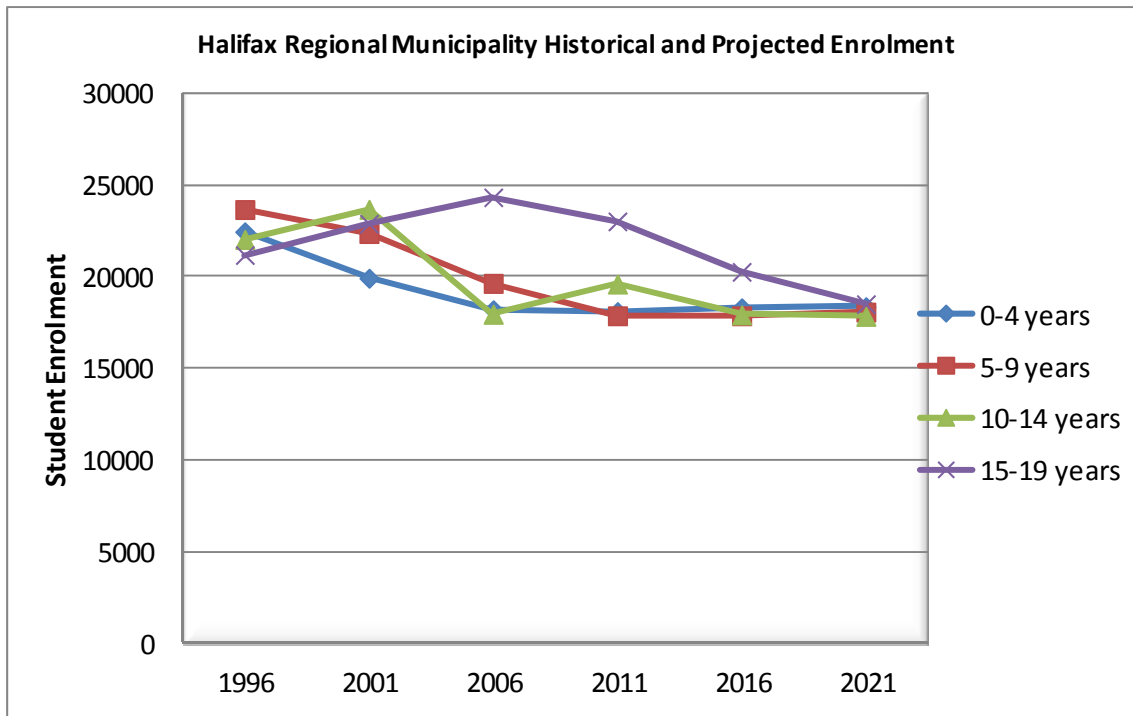

2.5.3 Central HRM Planning Area Historical and Projected Population

Historical Population

- The total population of the Eastern Central HRM planning area increased by 5.8% from 1996 to 2006.
- During this same period the age 5 to 19 population decreased by 2.8%.
- The age 0 to 4 population decreased by 23.3% in the same time frame.

Projected Population

- The age 5 to 19 population comprised 19.5% of the total population in 1996 and remained relatively steady at 18.4% of the total population in 2006. This value is estimated to steadily decline to 13.4% in 2021.

**Central Halifax Regional Municipality (Lockview High, Millwood High, and Sackville High Families of Schools)
Historical and Projected Population**

Age Cohort	1996	2001	2006	2011	2016	2021
0 to 4	3,780	3,175	2,925	2,817	2,793	2,731
5 to 9	4,015	3,820	3,325	3,056	2,933	2,907
10 to 14	3,820	4,085	3,965	3,455	3,154	3,022
15 to 19	3,715	3,775	3,945	3,813	3,313	3,019
20 to 24	3,220	2,925	2,845	3,019	2,835	2,352
25 to 29	3,325	2,845	2,680	2,625	2,803	2,596
30 to 34	4,920	3,730	3,495	3,294	3,252	3,433
35 to 39	4,845	5,055	4,240	3,922	3,690	3,652
40 to 44	4,295	4,730	5,100	4,280	3,939	3,709
45 to 49	4,175	4,165	4,670	5,025	4,201	3,860
50 to 54	2,965	3,920	3,945	4,433	4,755	3,923
55 to 59	1,845	2,735	3,660	3,626	4,095	4,369
60 to 64	1,305	1,715	2,670	3,574	3,567	4,014
65 to 69	910	1,215	1,610	2,503	3,362	3,365
70 to 74	645	795	1,065	1,419	2,208	2,963
75 to 79	445	570	625	843	1,131	1,768
80 to 84	275	305	405	432	584	786
85 to 89	80	120	185	240	250	334
90 and over	40	60	90	135	180	203
Total Population	48,620	49,740	51,445	52,511	53,045	53,006

Sources: Statistics Canada (historical), Environmental Design and Management Ltd (projected).
Figures do not include Census under-count.

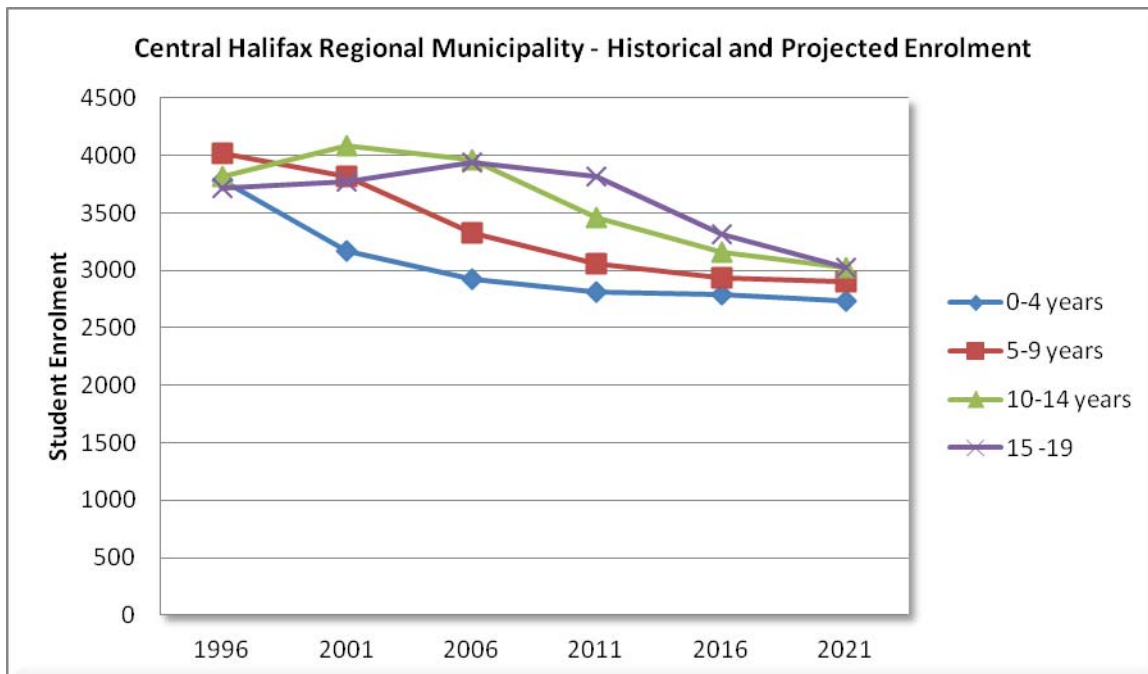

2.6 ENROLMENT

Enrolment projections are based upon the Cohort-Survival Method, which uses historical grade by grade enrolment to estimate a grade by grade projection for each program offered at a school. This method uses trends to identify the progression of students from one grade to the next higher grade. Other data sources, including historical migration rates (+/-) of the catchment area, analysis of out-of-area students, feeder school analysis, and an analysis of the Universal Child Benefit tax record and Canada Child Tax Benefit Tax records on a yearly basis are used to supplement the Cohort-Survival Method projections.

2.6.1 Historical and Projected Enrolment for HRSB 1998/1999 to 2017/2018

Over the past ten years, the total student enrolment in the Halifax Regional School Board has shown a steady decline. As of 2010/2011 enrolment has decreased by 8,128 students from the total enrolment of 58,297 in 1998/1999.

Over the next five to seven years, enrolments are estimated to continue to marginally decline with the most significant decline having occurred. The construction of new housing and a positive migration rate have helped mitigate some of the decline that has occurred during the past ten years. The projections indicate a decrease of approximately 1700 students from the registered enrolment of September 2010 to the projected enrolment of 2017.

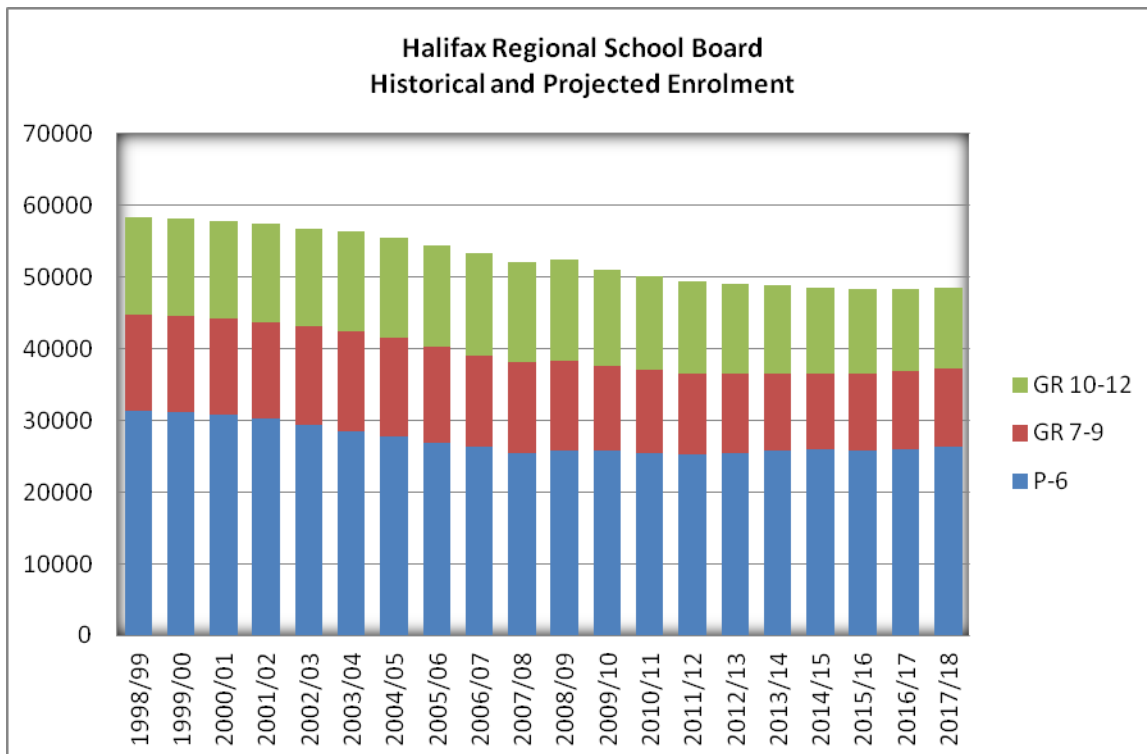

2.6.2 Sackville High Family of Schools Enrolment by Grade

The following charts outline the historical enrolment and the projected enrolment in Sackville High Family of Schools. According to this data the total enrolments will continue to significantly decline.

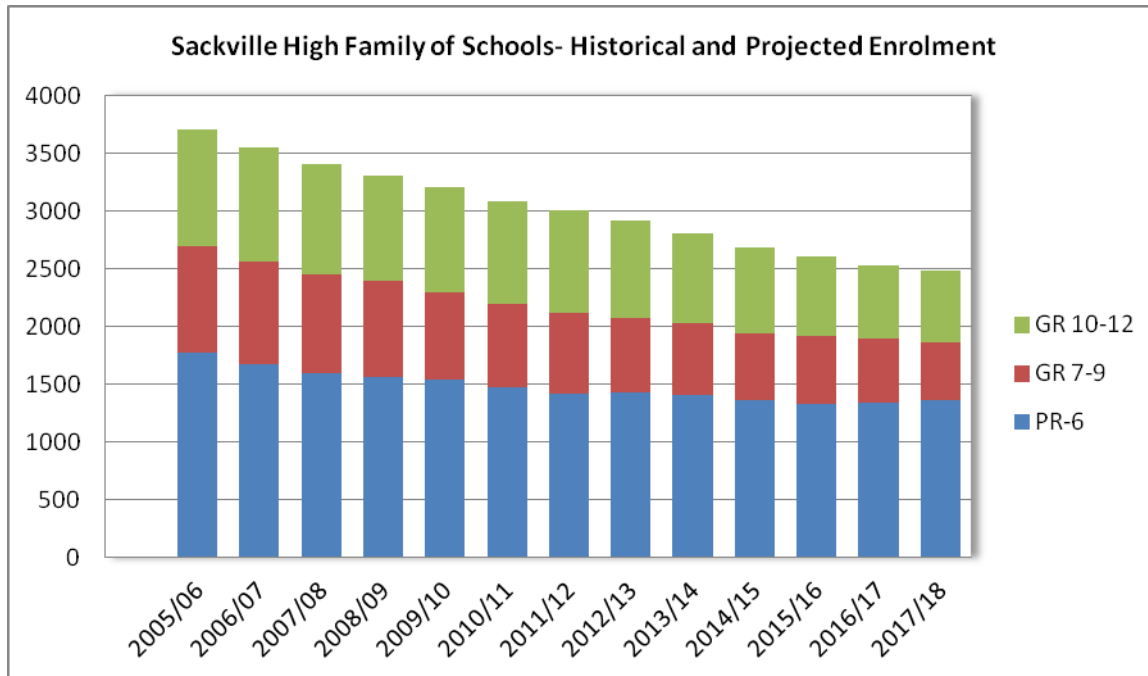

2.6.3 Sackville Centennial Elementary School Historical and Projected Enrolments

Sackville Centennial Elementary School provides regular programming for grades Primary to six. Actual enrolments are given through 2010 and projected enrolments are provided through 2015. Projections provided by Baragar Demographics.

Historical and Projected Enrolments of Sackville Centennial Elementary School

	2005	2006	2007	2008	2009	2010	2011	2012	2013	2014	2015
Primary	18	18	16	12	16	13	17	13	15	15	17
One	17	19	13	19	11	14	13	18	13	16	16
Two	13	16	16	16	17	14	15	14	18	14	16
Three	20	10	15	17	16	16	13	15	15	19	14
Four	19	17	11	14	17	17	16	13	15	14	19
Five	16	19	14	13	14	15	17	16	13	15	14
Six	27	19	14	14	16	13	15	17	16	13	15
Total	130	118	99	105	107	100	106	106	105	106	112

Source: Halifax Regional School Board and Baragar Demographics

2.6.4 Sackville Centennial Elementary School In and Out of Boundary Details

Students attending Sackville Centennial Elementary – September 2010

- 91 students living within Sackville Centennial Elementary School Boundary
- 9 students living in other elementary school boundaries
- Total of 100 students attending Sackville Centennial Elementary as of September 30, 2010

Students living in the Sackville Centennial boundary – September 2010

- 91 students from the Sackville Centennial Elementary School Boundary attend the school as of September 30, 2010;
- 11 students from the Sackville Centennial Elementary School Boundary attend other schools as of September 30, 2010.

2.6.5 Sackville Centennial Elementary School Registered Enrolment for September 2011

The following registered enrolments for September 2011 are accurate as of April 30, 2011. The actual September 30, 2011 enrolments will be provided to the School Review Committee in October 2011.

Grade	Enrolment as of April 30, 2011
Primary	10
One	13
Two	14
Three	12
Four	16
Five	17
Six	15
Total	97

2.7 CAPITAL CONSTRUCTION PLANNING

2.7.1 Halifax Regional Municipality Regional Plan

Sackville Centennial Elementary School and its catchment area are designated Urban Settlement in the HRM Regional Municipal Planning Strategy. The designation includes developed and undeveloped lands and includes six sites as potential areas for new urban growth.

Within each designation, there are a series of mixed use transit oriented centres. The Sackville Centennial catchment area is located in the suburban local centre. Permitted land uses in the suburban local centre include a mix of low to medium density residential and convenience commercial uses. In established neighbourhoods, low to medium density residential uses would be encouraged.

The HRM Regional Plan states that approximately 25% of the growth in the next 25 years will be targeted to occur in the Regional Centre; approximately 50% of the growth will occur in the suburban areas; and the remaining 25% will occur within the rural areas.

During the development of the Regional Plan, HRM had a demographic study prepared by Clayton Research. They found that the projected housing demand by type from 2001-2026 for the Suburban region to be:

Single and Semis:	18,851
Row:	735
Apartments and others:	11,013
Total:	30,599

2.7.2 HRM Facility Master Plan

The Communities Facilities Master Plan (CFMP) was approved in principle in May 2008. The objective of the CFMP is to specifically indicate where facilities will be constructed; which existing facilities will be improved; and joint school use agreements and partnerships for community facilities throughout HRM over the next 20 years.

The Municipality has indicated the Sackville area is well serviced and should Sackville Centennial Elementary School be closed, the site would not be considered for community use. Should this site be returned to the Municipality, the real estate division of transportation public works would initiate a formal assessment regarding future use of the building and site.

2.7.3 Community Visioning

HRM has been undertaking visioning exercises to further develop ideas for identified growth centres within the HRM Regional Plan. To date, the visioning process has not been initiated for the Lower Sackville area.

2.7.4 Proposed Development

HRM Planning and Development Services have provided the following development numbers for the Sackville Centennial and Hillside Park catchment areas:

- July 2009 – June 2011 – 83 residential building permits have been issued – 78 of which were multiple unit dwellings and 82 occupancy permits have been issued; and
- Anticipated development (in process, not approved) – 72 unit multiple unit dwelling located on Sackville Drive

2.8 PHYSICAL CONDITION OF BUILDING

2.8.1 Condition of Building Envelope, Interior and Systems

A complete Building Audit and Expenditure Plan has been completed for Sackville Centennial Elementary School and will be provided to the School Review Committee. The intent of the document is to provide a review of the existing building and to provide a capital building estimate that would be required for the continued operation of the school. The report concludes that an investment in capital of approximately \$759,900 is required to ensure the future use of the building.

2.8.2 Indoor Air Quality and Environmental Issues

The Review Committee will be provided with any past investigations regarding indoor air quality and environmental issues at Sackville Centennial Elementary School.

2.8.3 Costs Associated with Maintenance, Repair and Operation

Costs	2009/2010	2010/2011
Utilities		
Phone	\$3,300.00	\$3,300.00
Power	\$18,969	\$14,752.79
Fuel	\$9,334.80	\$13,182.59
Water	\$3,518.03	\$7,900.90
Maintenance	\$11,995.77	\$12,395.77
Caretaker and Supplies	\$51,330.15	\$52,619.94
Total	\$98,447.75	\$104,151.99

2.8.4 Barrier Free Accessibility to Building and Grounds

Please refer to the Building Audit and Expenditure Plan.

2.9 BUILDING USE

2.9.1 Floor plan

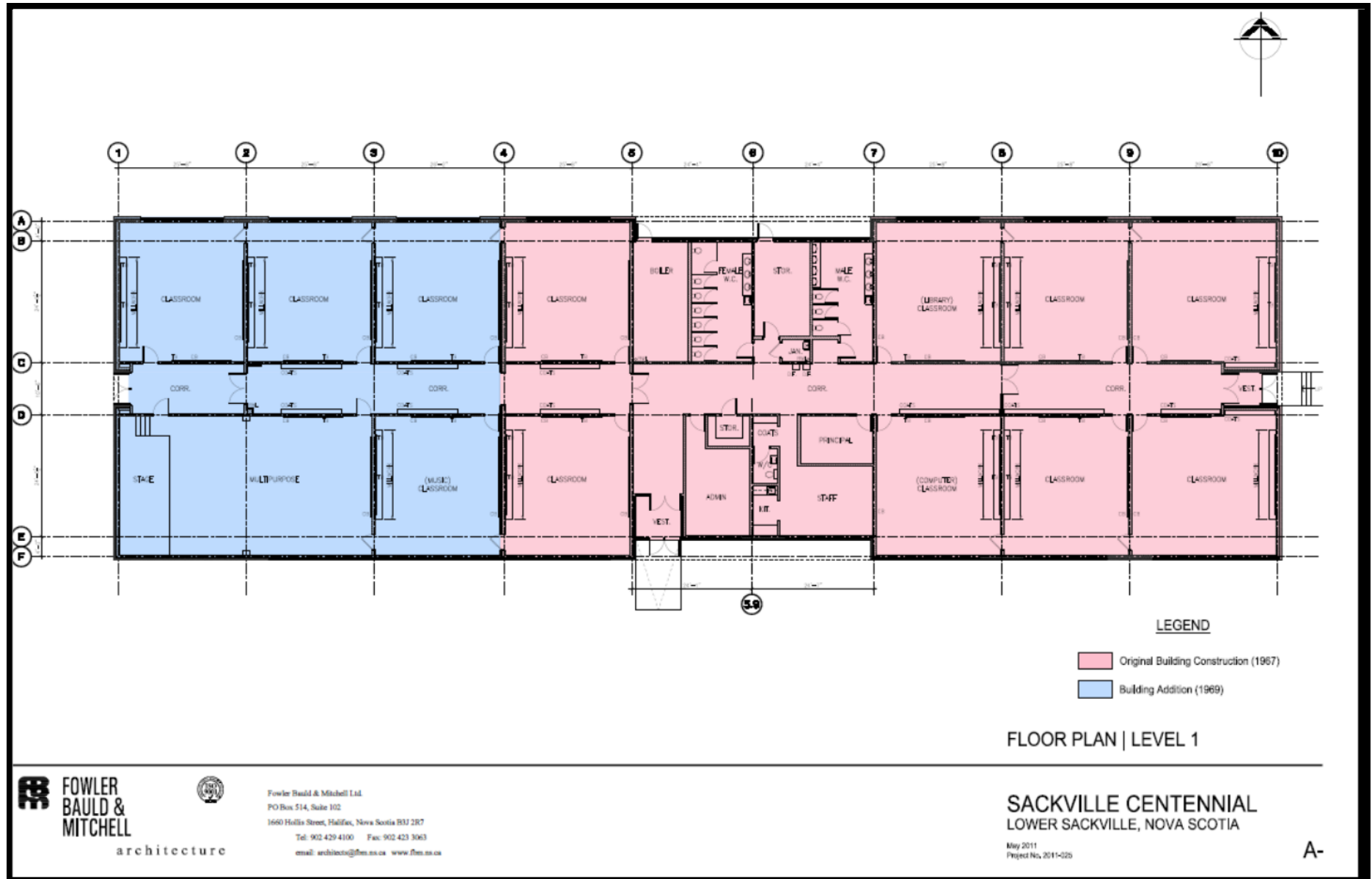

2.9.2 Building Details

Gross building square footage: 15,915

No. of storeys: 1

Building Age: 1967, addition 1969

Accessibility: Ramp

Elevator (Y/N): N/A

Average teaching space net square footage:

Note: this number is derived from adding the square footage of each room used as a classroom divided by the total number of classrooms.

2.9.3 Teaching Spaces and Current Usage

Room	Intended Use	Current Use
Ground Floor		
Classroom 100	Classroom	Student Services Office*
Classroom 102	Classroom	Classroom*
Classroom 104	Classroom	Classroom*
Classroom 106	Classroom	Resource/Book Room*
Classroom 116	Classroom	Library**
Classroom 118	Classroom	Core French**
Classroom 120	Classroom	Classroom*
Classroom 119	Classroom	Classroom*
Classroom 117	Classroom	Classroom*
Classroom 115	Classroom	Computer Lab*
Classroom 105	Classroom	Learning Centre**
Classroom 103	Classroom	Music Room**
Classroom 101	Gym/Assembly Hall	Gym/Assembly Hall**

* denotes a room that was considered as classroom space.

** denotes a room that was considered as a specialty area (i.e. Music).

2.9.4 Excess Teaching Spaces

Sackville Centennial has 8 classroom spaces and 5 specialty spaces available (Gym, Learning Centre, Library, Music and Core French).

Under the attached classroom configuration, Sackville Centennial requires 5 of the 8 available classroom spaces, leaving three classroom spaces available for other uses (i.e. Resource, EXCEL, etc.)

2.9.5
Sackville Planning Area

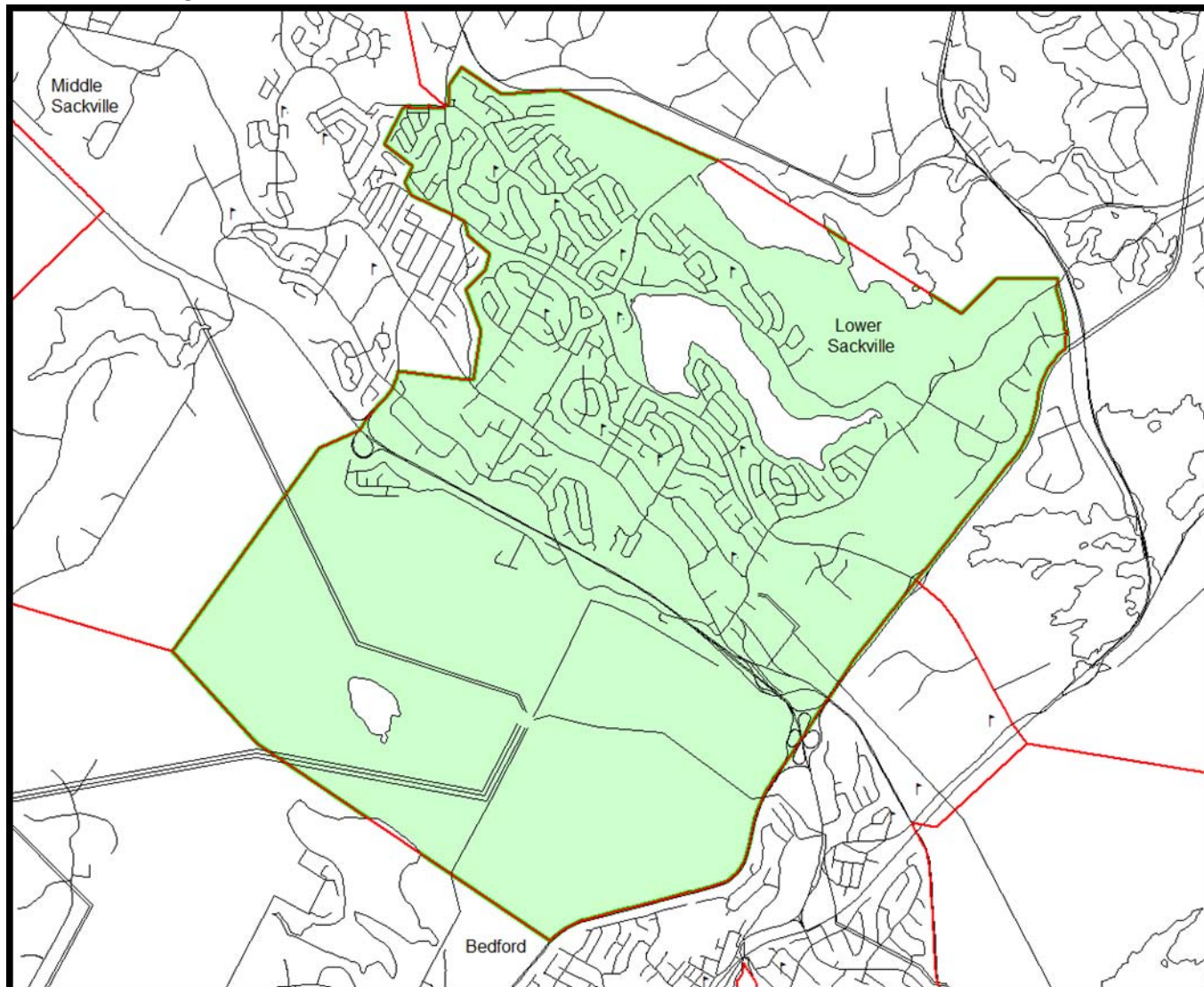

Source: Halifax Regional School Board and Baragar Demographics

Existing Sackville Centennial Boundary

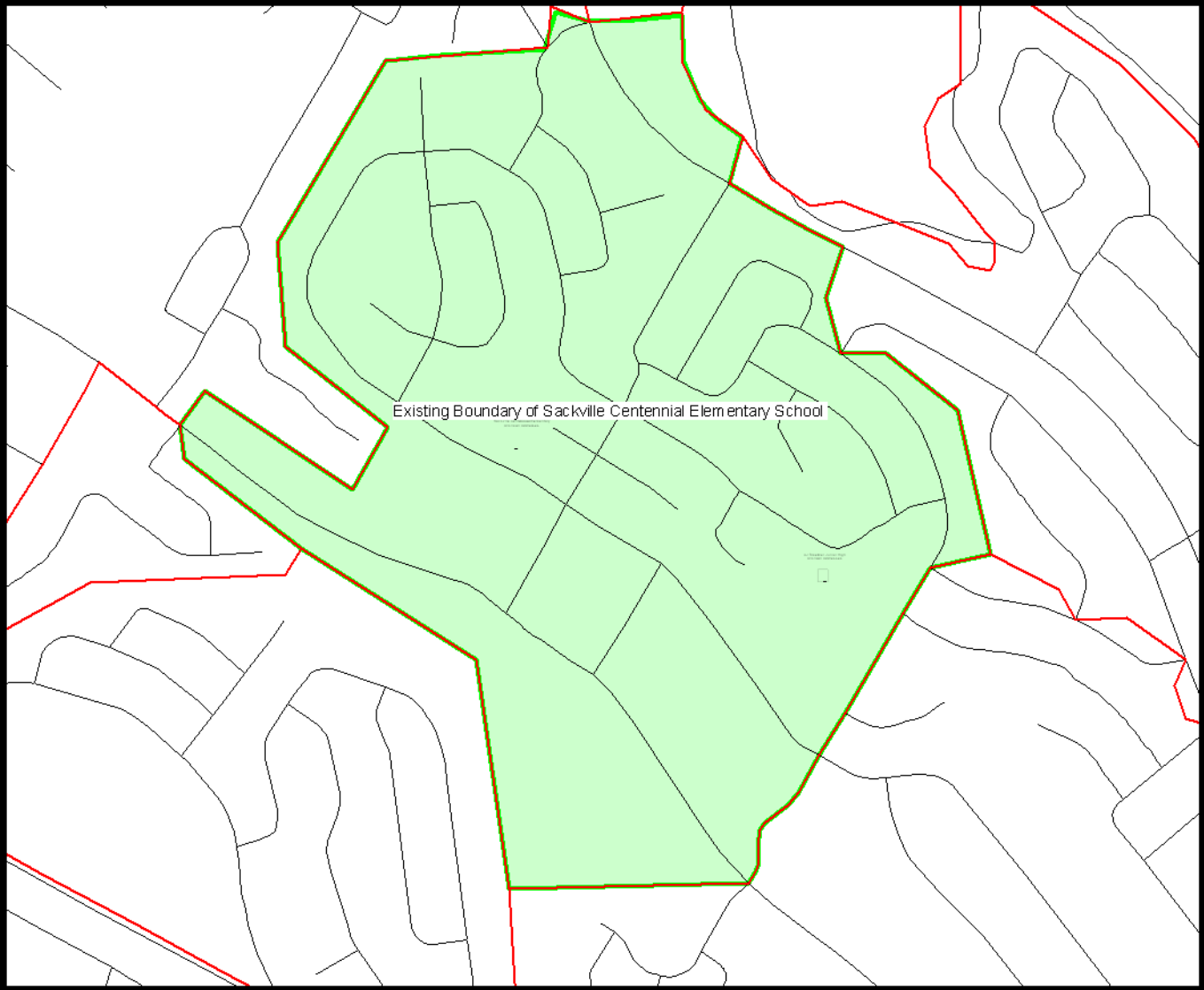

Source: Halifax Regional School Board and Baragar Demographics

3.0 IMPACT ANALYSIS

3.1 CAPABILITY TO DELIVER PUBLIC SCHOOL PROGRAM

ABILITY AS A FACILITY TO DELIVER THE PUBLIC SCHOOL PROGRAM

Facility Program Delivery Review is a term used to define how well an educational facility serves the academic program being offered. It does not refer to the quality of the school’s academic programs or the success of its students measured by test scores. A Facility Program Delivery Review does not reflect the state of the physical plant of the building for architectural, structural, mechanical or electrical conditions.

A Facility Program Delivery Review was conducted by the consultants for all schools in the Imagine Our Schools planning process.

Facility Program Deliver Review Results for Sackville Centennial Elementary School

Facility Program Delivery Review Observations					
	Poor	Fair	Average	Above Average	Excellent
Site Condition					
Educational Areas					
Classrooms					
Other Instructional Areas					
Library					
Gymnasium					
Support Areas					
Administration/Student Services					
Cafeteria/Food Services (none)					

3.1.2 Public School Programming

The following are details regarding Sackville Centennial's ability to deliver the public school program based on data from June 30, 2011. It is noted that Sackville Centennial is currently delivering the public school program as mandated by the Province.

- Pupil-Teacher Ratio = 18.4:1 (enrolment divided by classroom teachers only)
- Pupil-Staff Ratio = 17.4:1 (enrolment divided by all NSTU staff assigned to the school which includes Principals, Vice Principals, Circuit Teachers, Student Services Staff, ESL, Reading Recovery, Math Mentors, etc.)
- Enrolment: 92
- Total Classes: 5
- Number of Combined Classes: 3
- Class sizes:

Primary/ Grade 1	Grade 2	Grade 3	Grade 4/5	Grade 5/6
10/10	13	14	12/16	6/17

Program	Program Delivery Comments
General Classroom Program	Program is being delivered effectively.
Physical Education	Program is being delivered effectively. Teacher is in a circuit with one other school. Small Gym.
Art	Program is being delivered effectively by the classroom teachers.
Music	Program is being delivered effectively. Teacher is in a circuit with one other school.
French Core	Program is being delivered effectively. Teacher is in a circuit with one other school.
Computer Lab	Computer Lab.
Learning Centre	Provided in a classroom-sized space.
Resource Room	Provided in a classroom-sized space.
Specialty Space	Some available (i.e. Core French, Music)
Library	Library in a converted classroom.
Science Lab	N/A
Family Studies	N/A
Technology Education	N/A
Extra- Curricular	Running club, volleyball, cross country and floor hockey after school throughout the year. Also, intramurals, choir, and leadership program during regular school hours.
Playground	The playground consists of one large playground equipment site, swings, baseball field/soccer field and two paved pads: one for basketball and the other for four square.
Field	Baseball /soccer field.
Food services	Lunch Room provided in an unused classroom.

3.2 EDUCATIONAL BENEFITS

In general, the ability for a school to staff for specialty programs and extra-curricular activities is enhanced with larger student populations. This can occur because more teaching staff can be allocated to the school in either full time positions or they are in the school for longer periods of time as part of a circuit. While each individual student's exposure to certain subjects is defined by the curriculum offered and is consistent throughout the board, the fact that art, music, gym and French teachers are able to spend more time at a school with larger pupil numbers allows for the teachers to become more familiar with their students, enhances the ability for extra-curricular offerings and enhances the ability for students with special interests in those subjects to be exposed to the subject(s) in more depth.

Possible Outcome:

Sackville Centennial remains opens:

Sackville Centennial is currently delivering the required educational support services and public school program. The school has room to effectively provide appropriate spaces for a library, specialty areas such as French and Music, and dedicated lunch supervision space.

Sackville Centennial closes and students are moved to Hillside Elementary.

In the event that Sackville Centennial is closed, the students could continue to be supported effectively at Hillside Park Elementary with respect to the public school program.

3.3 TRANSPORTATION

Possible Outcome: Sackville Centennial remains open.

Students within the boundary of Sackville Centennial Elementary School are within walking distance of the school. No students are bussed to Sackville Centennial Elementary.

Possible Outcome: Sackville Centennial closes and students are redirected to Hillside Park Elementary.

No students would be entitled to bussing under the current 2.4 walking distance.

3.4 EXTRA-CURRICULAR ACTIVITIES

It should be noted that the delivery of extra-curricular activities at any school is dependent on the staff at the school in any given year. The special interests and skills of the teaching staff along with their availability to provide extra-curricular activities generally define what is offered. Extra-curricular activities are often offered over lunch periods or after school.

Possible Outcome: Sackville Centennial closes and the students are moved to Hillside.

Students will be able to access the extra-curricular activities offered at Hillside. The extra-curricular activities currently in place at Hillside may be enhanced due to the addition of new teachers at that site.

3.5 OPERATIONAL AND CAPITAL REQUIREMENTS

3.5.1 Completed Capital Projects at Sackville Centennial Elementary School

- Remove and replace cork boards window panels - \$5,836.56

3.5.2 Immediate Operating Needs (5 years)

If Sackville Centennial Elementary were to remain open, the following deferred maintenance and capital upgrades would need to occur over the next 5 years.

- Expand parking lot – pave and speed bumps – 75,000

3.5.3 Capital Investments on Current Building

A complete Building Audit and Expenditure Plan has been completed for Sackville Centennial Elementary School and will be provided to the School Review Committee. The intent of the document is to provide a review of the existing building and to provide a capital building estimate that would be required for the continued operation of the school. The report concludes that an investment in capital of approximately \$759,900.00 is required to ensure the future use of the building.

3.6 PROPERTY SERVICE EFFICIENCIES

The projected cost savings to the Board for each possible outcome of the review are listed below. Please note that administrative cost savings are not included in the calculations below.

Possible Outcome: Sackville Centennial Elementary remains open

	Immediate Capital Costs 5 yr	Long Term Capital Costs	Annual Operating Costs	Students	Annual Operating Costs/Student
Sackville Centennial	\$75,000.00	\$759,900.00	\$104,151.99	100	\$1,041.52
Hillside Park	\$133,920.00	\$848,805	\$161,074.53	207	\$778.13
Total Costs	\$208,920	\$1,608,705	\$265,226.52	307	\$863.93
Overall Cost Savings	0	0	0		0

Possible Outcome: Sackville Centennial is closed and students attend Hillside Park School

	Immediate Capital Costs 5 yr	Long Term Capital Costs	Annual Operating Costs	Students	Annual Operating Costs/Student
Sackville Centennial	0	0	0	0	0
Hillside Park	\$133,920	\$848,805	\$161,074.53	307	\$524.67
Total Costs	\$133,920	\$848,805	\$161,074.53	307	\$524.67
Overall Cost Savings	\$208,920 over 5 years	\$759,900 over 20 years	\$104,151.99/year		

3.7 IMPACT ON THE COMMUNITY

If Sackville Centennial Elementary School were to close, the impact on the community surrounding the school would be largely related to the school's proximity and convenience to families that reside in the area.

3.8 COMMUNITY USE OF THE SCHOOL

From September 2010 to June 2011, the following activities occurred at Sackville Centennial Elementary School. Source of this information is the HRSB/HRM Facility Booking database.

Rooms: Classroom

Booked by: EXCEL

Dates: September 2010 to June 2011

Times: 7:30 a.m. to 8:20 a.m.

2:15 p.m. to 6:00 p.m.

Rooms: Gymnasium

Booked by: School Usage

Dates: September 2010 to June 2011

Times: 3:00 p.m. to 6:00 p.m.

The school was not used by the community during the 2010-2011 school year. All community use functions that occur at Sackville Centennial Elementary School could occur at Hillside Park Elementary School.

3.9 IMPACT OF POTENTIAL CONSOLIDATION (IF APPLICABLE)

N/A

4.0 PROPOSED RECEIVING SCHOOL INFORMATION

4.1 SCHOOL NAME

Hillside Park Elementary School

4.2 SCHOOL LOCATION

15 Hillside Ave.
Lower Sackville, NS B4C 1W6

4.3 ADMINISTRATION

Principal: Karla Wolfe
Vice Principal: Lisa Taylor

4.4 ENROLMENT

4.4.1 Hillside Park Elementary School Historical and Projected Enrolments

Actual enrolments are given through 2010 and projected enrolments are provided through 2015. Projections provided by Baragar Demographics.

Historical and Projected Enrolments for Hillside Park Elementary School

	2006	2007	2008	2009	2010	2011	2012	2013	2014	2015
Primary	33	29	23	35	23	23	25	22	23	24
One	33	35	34	22	36	22	21	24	20	21
Two	29	35	36	33	24	35	21	20	23	20
Three	38	29	37	31	36	22	33	19	19	21
Four	23	34	30	32	31	35	22	32	19	19
Five	31	23	32	28	33	29	33	21	31	18
Six	36	30	26	30	24	28	24	29	17	25
Total	223	215	218	211	207	194	179	167	152	148

Source: Halifax Regional School Board and Baragar Demographics

4.4.2 Hillside Park Elementary School In and Out of Boundary Details

Students attending Hillside Park Elementary School – September 2010

- 190 students living within the Hillside Park Elementary School Boundary
- 17 students living in other school boundaries
- Total of 207 students attending Hillside Park Elementary as of September 30, 2010

Students living in Hillside Park Elementary – September 2010

- 190 students from the Hillside Park Elementary School Boundary attend the school as of September 30, 2010;
- 30 students from the Hillside Park Elementary School Boundary attend other schools in English programming as of September 30, 2010
- 8 students from the Hillside Park Elementary School Boundary attend other school in French Immersion programming as of September 30, 2010

4.4.3 Hillside Park Elementary School Registered Enrolment for September 2011

The following registered enrolments for September 2011 are accurate as of April 30, 2011. The actual September 30, 2011 enrolments will be provided to the School Review Committee in October 2011.

Grade	April 30, 2011 Registered Enrolment for September 2011
Primary	25
One	25
Two	24
Three	37
Four	25
Five	34
Six	32
Total	202

4.4.4 Impact of the Review Outcome on Hillside Park Elementary School

If Sackville Centennial Elementary School were to close effective September 2012, the entire student population would be assigned to Hillside Park Elementary School. Hillside is currently delivering the required educational support services and public school program. The school has room to effectively provide appropriate spaces for a library, specialty areas such as French and Music, and dedicated lunch supervision space.

Hillside has adequate space to accommodate the students from Sackville Centennial.

4.5 SCHOOL CONFIGURATION

Primary to Grade 6
Regular English Program

4.6 PHYSICAL CONDITION OF THE BUILDING

4.6.1 Facility Utilization

Capacity: 400
Enrolment September 30, 2010: 207
Utilization September 30, 2010: 52%

4.6.2 Condition of Building Structure and Systems

Completed Capital Projects at Hillside Park Elementary School

- Upgrade PA System – \$11,945.87
- Replace roof 'E' – \$64,315.74
- Cuppler on air replaced – \$6,706.15
- Replace roof (library) – \$78,724

Deferred Maintenance and Required Capital Upgrades over the next 5 years

- Windows and doors - \$80,000.00
- Roof replacement - \$53,920.00
- Total - \$133,920

Required Capital Upgrades

A complete Building Audit and Expenditure Plan has been completed for Hillside Park Elementary School and will be provided to the School Review Committee. The intent of the document is to provide a review of the existing building and to provide a capital building estimate that would be required for the continued operation of the school. The report concludes that an investment in capital of approximately \$900,225.00 is required to ensure the future use of the building.

4.6.3 Costs Associated With Maintenance and Operation

Costs	2006/2007	2007/2008
Utilities		
Phone	\$3,552.00	\$3,552.00
Power	\$24,669.89	\$24,403.69
Fuel	\$21,673.66	\$26,935.75
Water	\$10,225.29	\$9,224.00
Maintenance	\$12,269.43	\$12,669.43
Caretaker and Supplies	\$83,275.47	\$84,289.66
Total	\$155,665.74	\$161,074.53

4.6.4 Operation and Availability of Accessibility Ramps, Elevators, Accessible Playgrounds

Please refer to the Building Audit and Expenditure Plan.

4.7 BUILDING USE

4.7.1 Excess Space

Number of students as of September 30, 2010 = 194

Square footage = 28 816

4.7.2 Teaching Spaces and Current Usage

Room	Intended Use	Current Use
Ground Floor		
Classroom 146	Classroom	Classroom*
Classroom 147	Classroom	Teacher Work Room/Resource Room*
Classroom 148	Staff Room	Staff Room
Classroom 143	Classroom	Classroom*
Classroom 141	Classroom	Classroom*
Classroom 104	Classroom	Classroom*
Classroom 103	Classroom	Classroom*
Classroom 102	Classroom	Classroom*
Classroom 106	Classroom	Learning Centre*
Classroom 106	Classroom	Learning Centre**
Classroom 120	Library	Library**
Classroom 129	Art Room	EXCEL/Band/Breakfast Program*
Classroom 130	Music Room	Music Room**
Classroom 131	Gym/Assembly Hall	Gym/Assembly Hall**
First Floor		
Classroom 202	Classroom	Classroom*
Classroom 203	Classroom	Classroom*
Classroom 204	Classroom	Classroom*
Classroom 213	Classroom	Resource*
Classroom 207	Classroom	Resource*
Classroom 206	Classroom	Classroom*
Classroom 212	Classroom	Core French**

* denotes a room that was considered as classroom space.

** denotes a room that was considered as a specialty area (i.e. Music).

4.7.3 Impact of Increased Number of Students on Building Usage

Hillside Park Elementary has the necessary classroom space to accommodate the students currently enrolled at Sackville Centennial, leaving two classroom spaces in reserve.

4.8 TRANSPORTATION

Currently, there are students who qualify for bussing based on distance attending Hillside Park Elementary School.

4.9 PROPOSED ATTENDANCE BOUNDARY

If Sackville Centennial Elementary School were to close with students being redirected to Hillside Park Elementary School the new boundary would be as shown below.

Proposed Boundary of Sackville Centennial and Hillside Park

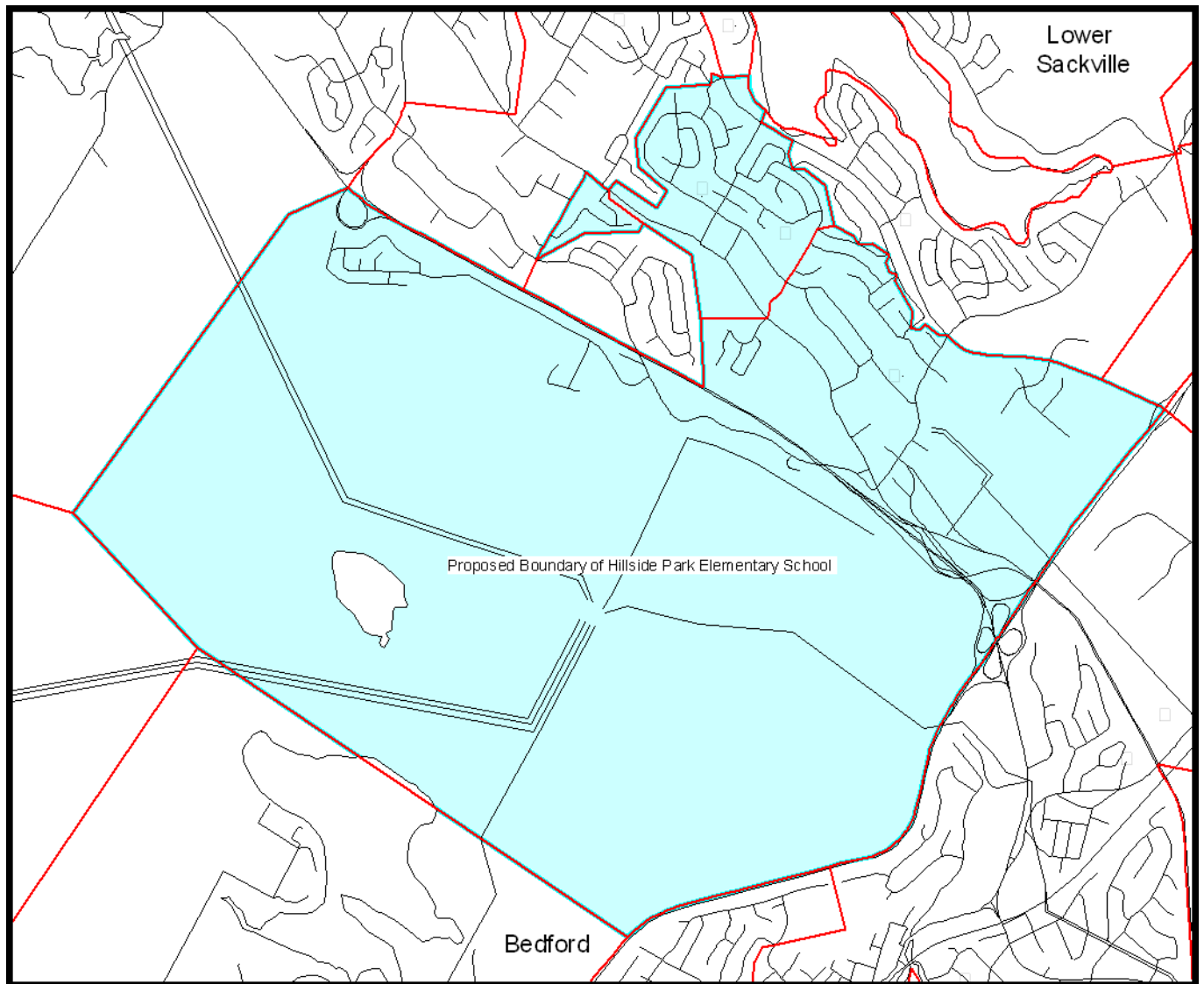

Source: Halifax Regional School Board and Baragar Demographics